

# Timber Roof Beach Villas by Foster + Partners

Shura Island, SA



## Project details

Client	Red Sea Global
Architecture	Foster + Partners
Project type	Hotels and restaurants, Leisure and sport
Construction type	Wood element construction
Locality	Shura Island
Country	Saudi Arabia

## The Red Sea Project: Luxury villas in the shape of shells

The architects of Foster + Partners are responsible for the design of Nujuma, a Ritz-Carlton Reserve in the Ummahat Island Resort. Blumer Lehmann is implementing the 82 beach villas with their shell-shaped timber shell roofs.

On behalf of The Red Sea Development Company, we are planning, manufacturing and supplying the timber construction elements for various hotels, water and beach villas, a spa and fitness building, restaurants and the reception building for the ambitious tourism project in Saudi Arabia. Also included in the contract is technical support and supervision during the construction phase for smooth assembly.

Foster + Partners designed Nujuma, a Ritz-Carlton Reserve on Ummahat Island. It consists of 82 beach villas arranged in a row across the island. Some of the villas stand on stilts in the water, others are placed directly on the ground. For the design of the beach villas, the architects chose a simple, gentle approach that takes care of the unspoiled nature of the island. The lightweight wooden construction meets this requirement. A total of 171 shells made of curved wooden elements form the roofs of the 76 beach villas and give them the appearance of a shell. The wooden elements for these roof shells as well as for the walls are prefabricated in our factory in Gossau - a total of 30 000 m<sup>2</sup> of wood will be used.

The timber construction method has the advantage that it burdens the environment with less noise and waste due to the high degree of prefabrication and the short construction time on site. After all, despite the gigantic dimensions, closeness to nature and sustainability are defined core objectives of the project.

[info@blumer-lehmann.com](mailto:info@blumer-lehmann.com)  
[blumer-lehmann.com](http://blumer-lehmann.com)

## Specific Contact



**Jephtha Schaffner**

Head of Timber Construction Planning | Free Form

T +41 71 388 52 27

[jephtha.schaffner@blumer-lehmann.com](mailto:jephtha.schaffner@blumer-lehmann.com)

**The fascinating world of wood**

# Timber Roof Beach Villas by Foster + Partners

Shura Island, SA



Die Strandvillen sind auf einer kreisförmigen Linie angeordnet und miteinander verbunden.



Einige der Strandvillen mit ihren muschelförmigen Holzdächern stehen auf Pfählen direkt im Wasser.

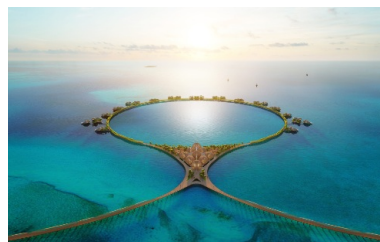
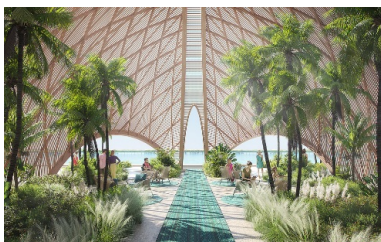

Im Innern von Hotel 12 kreieren die üppige Bepflanzung und das gewölbte Holzdach eine luftige Atmosphäre.

Die gesamte aussergewöhnliche Anlage des Hotel 12.